

DATA SHEET

Load Cells



Load cell with Digital tester and printer during the calibration of a compression tester.

General description

These high performance cells have been specially designed to meet the stringent requirement of EN, ISO and ASTM Standards, for calibration of compression testing machines. The cells have to be connected to a suitable Digital tester as, for example, our model 82-P0801/E Digimax Plus.

The Load cells connected to the Digital tester, can be supplied complete with Official or Traceable calibration certificate which, as specified, concern either the cell or the digital tester.

Main features

- High accuracy: Class 1 EN ISO 376
- Stainless steel construction
- Can be supplied with Official or Traceable calibration certificate

Standards

- EN 12390-4
- ASTM C39
- ASTM E74
- EN ISO 376

Specifications

Accuracy: Class 1 EN ISO 376

Linearity: $< \pm 0.05\%$ F.S.

Hysteresis: $< \pm 0.05\%$ F.S.

DATA SHEET

Repeatability 0° -120° -240°: $< \pm 0.145\%$ F.S.

Reversibility: $< \pm 0.240\%$ F.S.

Zero: $< \pm 0.030\%$ F.S.

Zero balance: $< \pm 1\%$ F.S.

Supply voltage: 10 V

Material: stainless steel

Connector type: MIL-C-5015 7 poles male

Complete with carrying case

| Model | Capacity kN | Dimensions, mm (dia. x height) | Weight approx., kg |
|--------------|-------------|-----------------------------------|-----------------------|
| 82-E0100/L5 | 5 | 57x117* | 1.5 |
| 82-E0100/L25 | 25 | 57x117* | 1.5 |
| 82-E0100/L30 | 30 | 82x149* | 4.2 |
| 82-E0100/5 | 50 | 82x149* | 4.2 |
| 82-E0100/L75 | 75 | 82x149* | 4.2 |
| 82-E0100/10 | 100 | 82x149* | 4.2 |
| 82-E0100/30 | 300 | 129x200 | 10 |
| 82-E0100/50 | 500 | 129x200 | 12 |
| 82-E0100/60 | 600 | 129x200 | 12 |
| 82-E0100/100 | 1000 | 129x200 | 14 |
| 82-E0100/200 | 2000 | 129x200 | 16 |
| 82-E0100/300 | 3000 | 129x200 | 18 |
| 82-E0100/500 | 5000 | 168x200 | 35 |

*Including spherical loading head

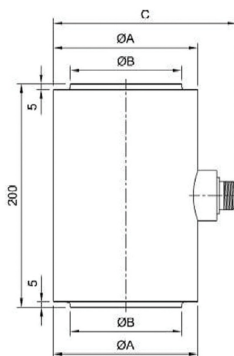

Load cells dimensions from 5000kN to 300kN (see additional information)

DATA SHEET

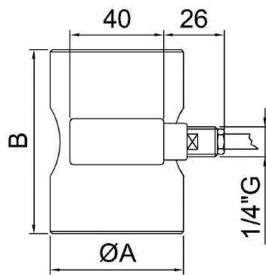

Load cells dimensions from 100kN to 5kN (see additional information)



Load cells from 5000kN to 300kN



Load cells from 100kN to 5kN

Products

82-E0100/30

Load cell 300 kN class 1 to EN ISO 376. Supplied complete with carrying case. Calibration certificate to be ordered separately when purchased with digital readout unit

82-E0100/L25

Load cell 25 kN class 1 to EN ISO 376. Supplied complete with carrying case. Calibration certificate to be ordered separately when purchased with digital readout unit

DATA SHEET

82-E0100/L5

Load cell 5 kN class 1 to EN ISO 376. Supplied complete with carrying case. Calibration certificate to be ordered separately when purchased with digital readout unit

82-E0100/10

Load cell 100 kN class 1 to EN ISO 376. Supplied complete with carrying case Calibration certificate to be ordered separately when purchased with digital readout unit

82-E0100/100

Load cell 1000 kN class 1 to EN ISO 376. Supplied complete with carrying case. Calibration certificate to be ordered separately when purchased with digital readout unit

82-E0100/200

Load cell 2000 kN class 1 to EN ISO 376. Supplied complete with carrying case. Calibration certificate to be ordered separately when purchased with digital readout unit

82-E0100/300

Load cell 3000 kN class 1 to EN ISO 376. Supplied complete with carrying case. Calibration certificate to be ordered separately when purchased with digital readout unit

82-E0100/5

Load cell 50 kN class 1 to EN ISO 376. Supplied complete with carrying case. Calibration certificate to be ordered separately when purchased with digital readout unit

82-E0100/500

Load cell 5000 kN class 1 to EN ISO 376. Supplied complete with carrying case. Calibration certificate to be ordered separately when purchased with digital readout unit

82-E0100/60

Load cell 600 kN class 1 to EN ISO 376. Supplied complete with carrying case. Calibration certificate to be ordered separately when purchased with digital readout unit

Accessories and consumables

82-E0100/ACC4

Official ACCREDIA (EAL) calibration certificate for the load cell connected to suitable digital tester for force verification. Calibration to EN ISO 376, 10 points, 4 cycles. (increasing forces only). Suitable for load cells from >1000 to 5000 kN.

82-E0100/TRC

Traceable calibration certificate for the load cell connected to suitable digital tester for force verification. Compatible with 5 kN up to 5000 kN capacity load cells.

82-E0100/ACC2

Official ACCREDIA (EAL) calibration certificate for the load cell connected to suitable digital tester for force verification. Calibration to EN ISO 376, 10 points, 4 cycles. (increasing forces only). Suitable for load cells from >10 to 600 kN

82-E0100/ACC3

Official ACCREDIA (EAL) calibration certificate for the load cell connected to suitable digital tester for force verification. Calibration to EN ISO 376, 10 points, 4 cycles. (increasing forces only). Suitable for load cells from >600 to 1000 kN.

82-E0100/ACC1

Official ACCREDIA (EAL) calibration certificate for the load cell connected to suitable digital tester for force verification. Calibration to EN ISO 376, 10 points, 4 cycles. (increasing forces only). Suitable for load cells from >1 to 10 kN